

This document, together with the concepts and designs presented herein, as an instrument of service, is intended only for the specific purpose and client for which it was prepared. Reuse of and improper reliance on this document without written authorization and adaptation by Kinney-Horn and Associates, Inc. shall be without liability to Kinney-Horn and Associates, Inc.

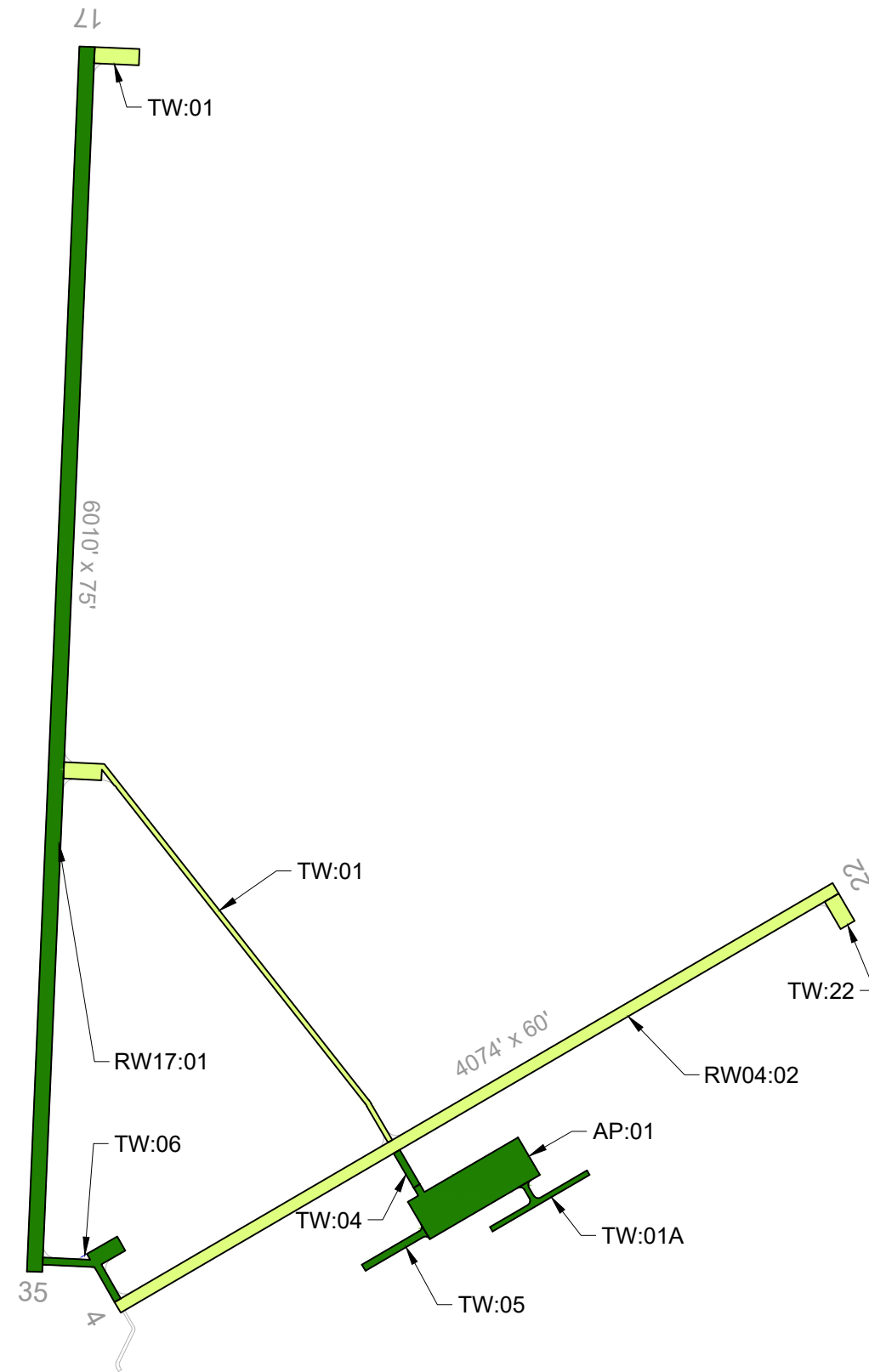

LEGEND

—	BRANCH IDENTIFIER
—	SECTION IDENTIFIER
—	SECTION BOUNDARY
■ (Dark Green)	PCI 86-100 GOOD
■ (Light Green)	PCI 71-85 SATISFACTORY
■ (Yellow)	PCI 56-70 FAIR
■ (Orange)	PCI 41-55 POOR
■ (Pink)	PCI 26-40 VERY POOR
■ (Red)	PCI 11-25 SERIOUS
■ (Grey)	PCI 0-10 FAILED

CURRENT 2024 PAVEMENT CONDITION INDEX

Branch ID	Section ID	Branch Name	Surface Type	Section Area (SF)	Approx. Age at Inspection	Last Major Work Date	Last Inspection Date	Pavement Condition Index	PCI Category
RW04	02	Runway 04-22	AAC	271,200	13.4	7/3/2011	10/8/2024	84	Satisfactory
RW17	01	Runway 17-35	AAC	450,000	15.3	8/1/2009	10/8/2024	86	Good
TW	01	Taxiway	AAC	108,800	15.3	8/1/2009	10/8/2024	83	Satisfactory
TW	01A	Taxiway	AC	15,450	3.2	9/15/2021	10/8/2024	100	Good
TW	04	Taxiway	AAC	8,925	13.9	1/1/2011	10/8/2024	89	Good
TW	05	Taxiway	AC	12,075	3.2	9/15/2021	10/8/2024	100	Good
TW	06	Taxiway	AC	35,840	14.1	9/30/2010	10/8/2024	92	Good
TW	22	Taxiway	AC	12,166	14.1	9/30/2010	10/8/2024	84	Satisfactory
AP	01	Apron	AC	134,393	3.2	9/15/2021	10/8/2024	99	Good

AIRFIELD PAVEMENT WORK HISTORY

1. AIP-001, 1985, REHABILITATE RUNWAY 4/22, TURNAROUNDS, APRON, AND CONNECTING TAXIWAY.
2. AIP-002, 1992, CONSTRUCT RUNWAY 16/34, CONNECTING AND ACCESS TAXIWAYS; APRON EXPANSION.
3. AIP-003, 1993, REHABILITATE RUNWAY (RW04:02) AND APRON, CONSTRUCT TAXIWAY (TW:05).
4. AIP-004, 2001, CRACK SEAL, FOG SEAL, AND REMARK ALL PAVEMENTS.
5. AIP-009-2007, CRACK SEAL, FOG SEAL, AND REMARK ALL PAVEMENTS [RE-BID AIP-008-2006].
6. AIP-010/011-2009, OVERLAY RUNWAY 16/34 (RW17:01) AND TAXIWAY (TW:01).
7. AIP-014-2011, OVERLAY RUNWAY 4/22 (RW04:02) AND TAXIWAY (TW:04); CONSTRUCT TAXIWAYS (TW:06, TW:22).
8. AIP 018-2019, CRACK SEAL, FOG SEAL, AND REMARK ALL PAVEMENTS.
9. AIP 021-2021, RECONSTRUCT APRONS (AP:01) AND TAXIWAYS (TW:01A, TW:05).
10. AIP 024-2024, CRACK SEAL, SURFACE SEAL, AND REMARK ALL PAVEMENTS [INSPECTED AFTER MAINTENANCE PROJECT].



This document, together with the concepts and designs presented herein, is intended only for the specific purpose and client for which it was prepared. Reuse of and improper reliance on this document without written authorization and adaptation by Kinney-Horn and Associates, Inc. shall be without liability to Kinney-Horn and Associates, Inc.

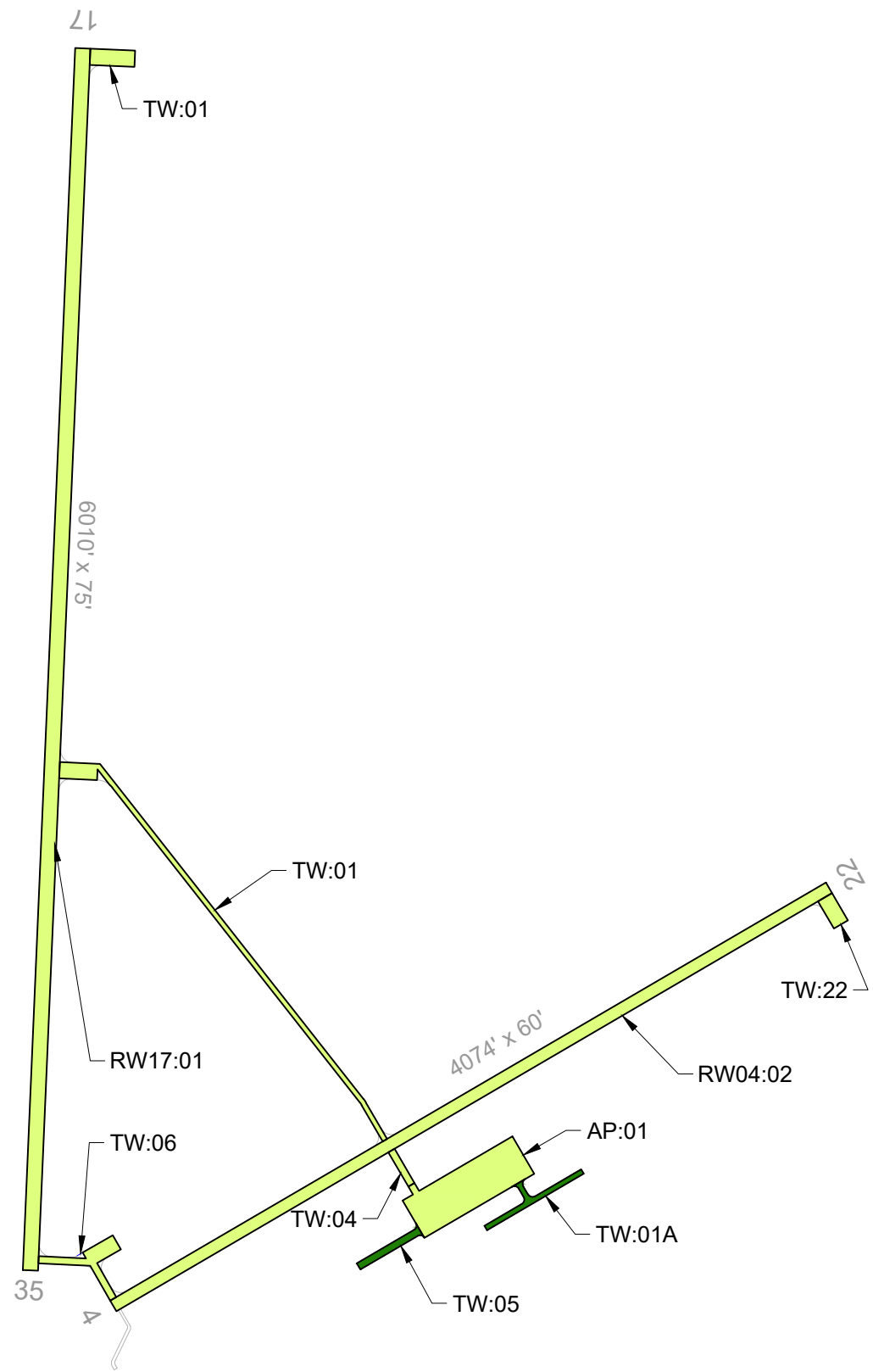

FORECASTED PAVEMENT CONDITION INDEX

Branch ID	Section ID	Surface Type	Current PCI (2024)	2025	2026	2027	2028	2029
RW04	02	AAC	84	84	82	81	79	78
RW17	01	AAC	86	86	84	82	81	79
TW	01	AAC	83	83	81	79	78	77
TW	01A	AC	100	99	96	93	91	88
TW	04	AAC	89	88	86	84	82	81
TW	05	AC	100	99	96	93	91	88
TW	06	AC	92	91	89	87	85	83
TW	22	AC	84	84	82	80	79	78
AP	01	AC	99	98	95	92	90	87

This document, together with the concepts and designs presented herein, is intended only for the specific purpose and client for which it was prepared. Reuse of and improper reliance on this document without written authorization and adaptation by Kinney-Horn and Associates, Inc. shall be without liability to Kinney-Horn and Associates, Inc.

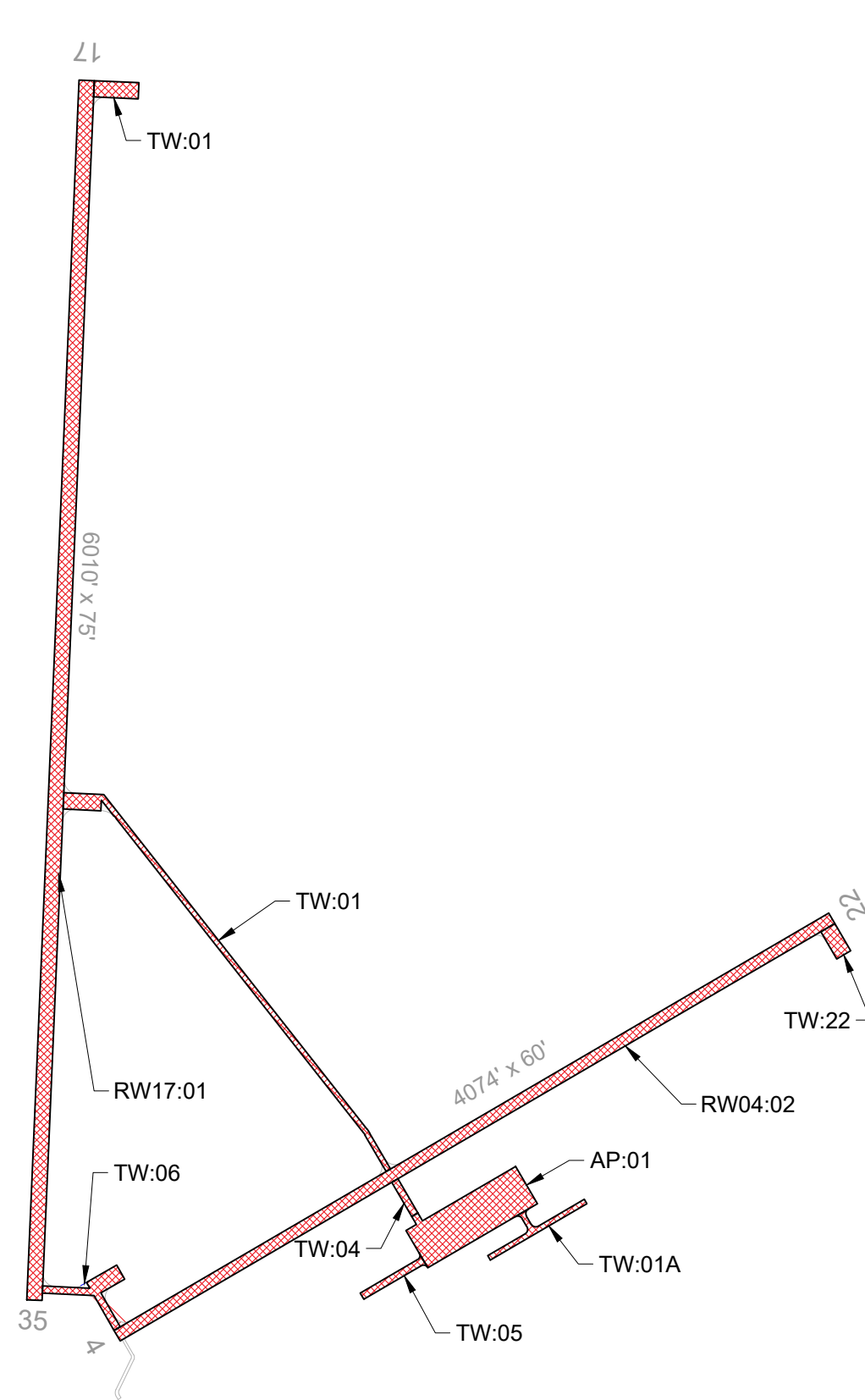

LEGEND

— BRANCH IDENTIFIER
 — SECTION IDENTIFIER
 - - - SECTION BOUNDARY

MAJOR REHABILITATION	GLOBAL TREATMENT
2025	2025
2026	2026
2027	2027
2028	2028
2029	2029

5-YEAR PAVEMENT NEEDS BY SECTION

Year	Branch ID	Section ID	Surface Type	Section Area (SF)	PCI at Treatment	Recommended Treatment	Treatment Category
2029	RW04	02	AAC	271,200	79	Crack Seal and Seal Coat	Global Treatment
2029	RW17	01	AAC	450,000	81	Crack Seal and Seal Coat	Global Treatment
2029	TW	01	AAC	108,800	78	Crack Seal and Seal Coat	Global Treatment
2029	TW	01A	AC	15,450	91	Crack Seal and Seal Coat	Global Treatment
2029	TW	04	AAC	8,925	82	Crack Seal and Seal Coat	Global Treatment
2029	TW	05	AC	12,075	91	Crack Seal and Seal Coat	Global Treatment
2029	TW	06	AC	35,840	85	Crack Seal and Seal Coat	Global Treatment
2029	TW	22	AC	12,166	79	Crack Seal and Seal Coat	Global Treatment
2029	AP	01	AC	134,393	90	Crack Seal and Seal Coat	Global Treatment



Runway



RW04-02-44: L&T Cracking



RW17-01-55: Overview

Taxiway



TW-04-01: L&T Cracking



TW-22-01: Overview

Apron



AP-01-10: Overview



AP-01-22: Overview

Re-Inspection Report

MDT SASP 2024

Generated Date 1/7/2025

Page 1 of 9

Network: 3U3	Name: Bowman Field (Anaconda) Airport			
Branch: AP	Name: Apron	Use: APRON	Area: 134,393 SqFt	
Section: 01	of 1	From: STA 0+00A	To: STA 6+34A	Last Const.: 9/15/2021
Surface: AC	Family: _MDT2024 - AP AC	Zone: ANAC	Category: D	Rank: P
Area: 134,393 SqFt	Length: 234 Ft	Width: 210 Ft		
Slabs:	Slab Length: Ft	Slab Width: Ft	Joint Length: Ft	
Shoulder:	Street Type: ACN	Grade: 0	Lanes: 0	

Section Comments:

Work Date: 7/30/1992	Work Type: New Construction - Initial	Code: NU-IN	Is Major M&R: True
Work Date: 9/15/2021	Work Type: Complete Reconstruction - AC	Code: CR-AC	Is Major M&R: True
Work Date: 1/1/2024	Work Type: Crack Sealing - AC	Code: CS-AC	Is Major M&R: False
Work Date: 1/1/2024	Work Type: Surface Treatment - Seal Coat	Code: ST-SC	Is Major M&R: False

Last Insp. Date: 10/8/2024 **TotalSamples:** 26 **Surveyed:** 5

Conditions: PCI: 99

Inspection Comments:

Sample Number: 02 **Type:** R **Area:** 5250.00 SqFt **PCI:** 97

Sample Comments:

48 L & T CR L 8.00 Ft

Sample Number: 08 **Type:** R **Area:** 5250.00 SqFt **PCI:** 100

Sample Comments:

<No Distress>

Sample Number: 10 **Type:** R **Area:** 4970.00 SqFt **PCI:** 100

Sample Comments:

<No Distress>

Sample Number: 18 **Type:** R **Area:** 4970.00 SqFt **PCI:** 100

Sample Comments:

<No Distress>

Sample Number: 22 **Type:** R **Area:** 6545.00 SqFt **PCI:** 100

Sample Comments:

<No Distress>

Network:	3U3	Name:	Bowman Field (Anaconda) Airport						
Branch:	RW04	Name:	Runway 04-22	Use:	RUNWAY	Area:	271,200 SqFt		
Section:	02	of	1	From:	Sta 0+00 RWY 4/22	To:	STA 45+20 RWY 4/22	Last Const.:	7/3/2011
Surface:	AAC	Family:	_MDT2024 - RW AC AAC	Zone:	ANAC	Category:	E	Rank:	P
Area:	271,200 SqFt	Length:	4,520 Ft	Width:	60 Ft				
Slabs:		Slab Length:	Ft	Slab Width:	Ft	Joint Length:	Ft		
Shoulder:		Street Type:	ACR	Grade:	0	Lanes:	0		
Section Comments:									
Work Date:	7/31/1993	Work Type:	New Construction - Initial		Code:	NU-IN	Is Major M&R:	True	
Work Date:	7/3/2011	Work Type:	Overlay - AC Structural		Code:	OL-AS	Is Major M&R:	True	
Work Date:	1/1/2019	Work Type:	Crack Sealing - AC		Code:	CS-AC	Is Major M&R:	False	
Work Date:	1/1/2019	Work Type:	Surface Seal		Code:	SS-LO	Is Major M&R:	False	
Work Date:	1/1/2024	Work Type:	Crack Sealing - AC		Code:	CS-AC	Is Major M&R:	False	
Work Date:	1/1/2024	Work Type:	Surface Treatment - Seal Coat		Code:	ST-SC	Is Major M&R:	False	
Last Insp. Date:	10/8/2024	TotalSamples:	54	Surveyed:	7				
Conditions:	PCI: 84								
Inspection Comments:									
Sample Number:	09	Type:	R	Area:	4800.00 SqFt	PCI:	85		
Sample Comments:									
48	L & T CR		L	242.00	Ft				
Sample Number:	16	Type:	R	Area:	4800.00 SqFt	PCI:	85		
Sample Comments:									
48	L & T CR		L	238.00	Ft				
Sample Number:	23	Type:	R	Area:	4800.00 SqFt	PCI:	83		
Sample Comments:									
48	L & T CR		L	285.00	Ft				
Sample Number:	30	Type:	R	Area:	4800.00 SqFt	PCI:	79		
Sample Comments:									
48	L & T CR		L	301.00	Ft				
48	L & T CR		M	3.00	Ft				
Sample Number:	37	Type:	R	Area:	4800.00 SqFt	PCI:	79		
Sample Comments:									
48	L & T CR		L	298.00	Ft				
48	L & T CR		M	3.00	Ft				
Sample Number:	44	Type:	R	Area:	4800.00 SqFt	PCI:	83		
Sample Comments:									
48	L & T CR		L	300.00	Ft				
Sample Number:	55	Type:	R	Area:	4800.00 SqFt	PCI:	92		
Sample Comments:									
48	L & T CR		L	108.00	Ft				

Network:	3U3	Name:	Bowman Field (Anaconda) Airport						
Branch:	RW17	Name:	Runway 17-35	Use:	RUNWAY	Area:	450,000 SqFt		
Section:	01	of	1	From:	Sta 0+00 RWY 16/34	To:	STA 60+00 RWY 16/34	Last Const.:	8/1/2009
Surface:	AAC	Family:	_MDT2024 - RW AC AAC	Zone:	ANAC	Category:	E	Rank:	P
Area:	450,000 SqFt	Length:	6,000 Ft	Width:	75 Ft				
Slabs:		Slab Length:	Ft	Slab Width:	Ft	Joint Length:	Ft		
Shoulder:		Street Type:	ACR	Grade:	0	Lanes:	0		
Section Comments:									
Work Date:	7/31/1992	Work Type:	New Construction - Initial		Code:	NU-IN	Is Major M&R:	True	
Work Date:	8/1/2009	Work Type:	Overlay - AC Structural		Code:	OL-AS	Is Major M&R:	True	
Work Date:	1/1/2019	Work Type:	Surface Seal		Code:	SS-LO	Is Major M&R:	False	
Work Date:	1/1/2019	Work Type:	Crack Sealing - AC		Code:	CS-AC	Is Major M&R:	False	
Work Date:	1/1/2024	Work Type:	Surface Treatment - Seal Coat		Code:	ST-SC	Is Major M&R:	False	
Work Date:	1/1/2024	Work Type:	Crack Sealing - AC		Code:	CS-AC	Is Major M&R:	False	
Last Insp. Date:	10/8/2024	Total Samples:	98	Surveyed:	7				
Conditions:	PCI: 86								
Inspection Comments:									
Sample Number:	07	Type:	R	Area:	4875.00 SqFt	PCI:	92		
Sample Comments:									
48	L & T CR		L	101.00	Ft				
Sample Number:	23	Type:	R	Area:	4875.00 SqFt	PCI:	89		
Sample Comments:									
48	L & T CR		L	173.00	Ft				
Sample Number:	39	Type:	R	Area:	4875.00 SqFt	PCI:	83		
Sample Comments:									
48	L & T CR		L	308.00	Ft				
Sample Number:	55	Type:	R	Area:	4875.00 SqFt	PCI:	86		
Sample Comments:									
48	L & T CR		L	224.00	Ft				
Sample Number:	71	Type:	R	Area:	4875.00 SqFt	PCI:	79		
Sample Comments:									
48	L & T CR		L	421.00	Ft				
Sample Number:	87	Type:	R	Area:	4875.00 SqFt	PCI:	86		
Sample Comments:									
48	L & T CR		L	236.00	Ft				
Sample Number:	98	Type:	R	Area:	4875.00 SqFt	PCI:	87		
Sample Comments:									
48	L & T CR		L	195.00	Ft				

Network: 3U3 **Name:** Bowman Field (Anaconda) Airport

Branch: TW **Name:** Taxiway **Use:** TAXIWAY **Area:** 193,256 SqFt

Section: 01 of 6 **From:** RWY 4/22 **To:** RWY 34/16, and Hangars **Last Const.:** 8/1/2009

Surface: AAC **Family:** _MDT2024 - TW AAC **Zone:** ANAC **Category:** E **Rank:** P

Area: 108,800 SqFt **Length:** 4,352 Ft **Width:** 25 Ft

Slabs: **Slab Length:** Ft **Slab Width:** Ft **Joint Length:** Ft

Shoulder: **Street Type:** ACR **Grade:** 0 **Lanes:** 0

Section Comments:

Work Date: 7/31/1992 **Work Type:** New Construction - Initial **Code:** NU-IN **Is Major M&R:** True

Work Date: 8/1/2009 **Work Type:** Overlay - AC Structural **Code:** OL-AS **Is Major M&R:** True

Work Date: 1/1/2019 **Work Type:** Surface Seal **Code:** SS-LO **Is Major M&R:** False

Work Date: 1/1/2019 **Work Type:** Crack Sealing - AC **Code:** CS-AC **Is Major M&R:** False

Work Date: 1/1/2024 **Work Type:** Crack Sealing - AC **Code:** CS-AC **Is Major M&R:** False

Work Date: 1/1/2024 **Work Type:** Surface Treatment - Seal Coat **Code:** ST-SC **Is Major M&R:** False

Last Insp. Date: 10/8/2024 **TotalSamples:** 20 **Surveyed:** 5

Conditions: PCI: 83

Inspection Comments:

Sample Number: 02 **Type:** R **Area:** 5000.00 SqFt **PCI:** 79

Sample Comments:

48 L & T CR L 431.00 Ft

Sample Number: 07 **Type:** R **Area:** 5000.00 SqFt **PCI:** 84

Sample Comments:

48 L & T CR L 271.00 Ft

Sample Number: 12 **Type:** R **Area:** 2825.00 SqFt **PCI:** 84

Sample Comments:

48 L & T CR L 154.00 Ft

Sample Number: 15 **Type:** R **Area:** 4960.00 SqFt **PCI:** 84

Sample Comments:

48 L & T CR L 278.00 Ft

Sample Number: 19 **Type:** R **Area:** 4400.00 SqFt **PCI:** 86

Sample Comments:

48 L & T CR L 198.00 Ft

Network:	3U3	Name:	Bowman Field (Anaconda) Airport						
Branch:	TW	Name:	Taxiway	Use:	TAXIWAY	Area:	193,256 SqFt		
Section:	01A	of 6	From:	Southeast corner	To:	A-1	Last Const.:	9/15/2021	
Surface:	AC	Family:	_MDT2024 - TW AC	Zone:	ANAC	Category:	D	Rank:	P
Area:	15,450 SqFt	Length:	618 Ft	Width:	25 Ft				
Slabs:	Slab Length:	Ft	Slab Width:	Ft	Joint Length:	Ft			
Shoulder:	Street Type:	ACR	Grade:	0	Lanes:	0			
Section Comments:									
Work Date:	8/1/1992	Work Type:	New Construction - Initial		Code:	NU-IN	Is Major M&R:	True	
Work Date:	9/15/2021	Work Type:	Complete Reconstruction - AC		Code:	CR-AC	Is Major M&R:	True	
Work Date:	1/1/2024	Work Type:	Crack Sealing - AC		Code:	CS-AC	Is Major M&R:	False	
Work Date:	1/1/2024	Work Type:	Surface Treatment - Seal Coat		Code:	ST-SC	Is Major M&R:	False	
Last Insp. Date:	10/8/2024	TotalSamples:	4	Surveyed:	3				
Conditions:	PCI: 100								
Inspection Comments:									
Sample Number:	01	Type:	R	Area:	4500.00 SqFt	PCI:	100		
Sample Comments:									
<No Distress>									
Sample Number:	02	Type:	R	Area:	4500.00 SqFt	PCI:	100		
Sample Comments:									
<No Distress>									
Sample Number:	04	Type:	R	Area:	4500.00 SqFt	PCI:	100		
Sample Comments:									
<No Distress>									

Network: 3U3 **Name:** Bowman Field (Anaconda) Airport

Branch: TW **Name:** Taxiway **Use:** TAXIWAY **Area:** 193,256 SqFt

Section: 04 of 6 **From:** RWY 4-22 **To:** APRON **Last Const.:** 1/1/2011

Surface: AAC **Family:** _MDT2024 - TW AAC **Zone:** ANAC **Category:** D **Rank:** P

Area: 8,925 SqFt **Length:** 255 Ft **Width:** 35 Ft

Slabs: **Slab Length:** Ft **Slab Width:** Ft **Joint Length:** Ft

Shoulder: **Street Type:** ACR **Grade:** 0 **Lanes:** 0

Section Comments:

Work Date: 7/31/1985 **Work Type:** New Construction - Initial **Code:** NU-IN **Is Major M&R:** True

Work Date: 1/1/2011 **Work Type:** Overlay-AC **Code:** OL-AC **Is Major M&R:** True

Work Date: 1/1/2019 **Work Type:** Crack Sealing - AC **Code:** CS-AC **Is Major M&R:** False

Work Date: 1/1/2019 **Work Type:** Surface Seal **Code:** SS-LO **Is Major M&R:** False

Work Date: 1/1/2024 **Work Type:** Surface Treatment - Seal Coat **Code:** ST-SC **Is Major M&R:** False

Work Date: 1/1/2024 **Work Type:** Crack Sealing - AC **Code:** CS-AC **Is Major M&R:** False

Last Insp. Date: 10/8/2024 **Total Samples:** 2 **Surveyed:** 2

Conditions: PCI: 89

Inspection Comments:

Sample Number: 01 **Type:** R **Area:** 4200.00 SqFt **PCI:** 92

Sample Comments:

48 L & T CR L 70.00 Ft
57 WEATHERING L 210.00 SqFt

Sample Number: 02 **Type:** R **Area:** 2625.00 SqFt **PCI:** 83

Sample Comments:

45 DEPRESSION L 48.00 SqFt
48 L & T CR L 54.00 Ft
57 WEATHERING L 131.00 SqFt

Network:	3U3	Name:	Bowman Field (Anaconda) Airport						
Branch:	TW	Name:	Taxiway	Use:	TAXIWAY	Area:	193,256 SqFt		
Section:	05	of 6	From:	Apron to Hangars	To:		Last Const.: 9/15/2021		
Surface:	AC	Family:	_MDT2024 - TW AC	Zone:	ANAC	Category:	D	Rank:	P
Area:	12,075 SqFt	Length:	345 Ft	Width:	35 Ft				
Slabs:		Slab Length:	Ft	Slab Width:	Ft	Joint Length:	Ft		
Shoulder:		Street Type:	ACR	Grade:	0	Lanes:	0		
Section Comments:									
Work Date:	7/31/1993	Work Type:	New Construction - Initial		Code:	NU-IN	Is Major M&R:	True	
Work Date:	9/15/2021	Work Type:	Complete Reconstruction - AC		Code:	CR-AC	Is Major M&R:	True	
Work Date:	1/1/2024	Work Type:	Crack Sealing - AC		Code:	CS-AC	Is Major M&R:	False	
Work Date:	1/1/2024	Work Type:	Surface Treatment - Seal Coat		Code:	ST-SC	Is Major M&R:	False	
Last Insp. Date:	10/8/2024	TotalSamples:	3		Surveyed:	3			
Conditions:	PCI: 100								
Inspection Comments:									
Sample Number:	01	Type:	R	Area:	4025.00 SqFt	PCI:	100		
Sample Comments:									
<No Distress>									
Sample Number:	02	Type:	R	Area:	4025.00 SqFt	PCI:	100		
Sample Comments:									
<No Distress>									
Sample Number:	03	Type:	R	Area:	4427.00 SqFt	PCI:	100		
Sample Comments:									
<No Distress>									

Network:	3U3	Name:	Bowman Field (Anaconda) Airport						
Branch:	TW	Name:	Taxiway	Use:	TAXIWAY	Area:	193,256 SqFt		
Section:	06	of 6	From:	RW 34	To:	RW 4	Last Const.:	9/30/2010	
Surface:	AC	Family:	_MDT2024 - TW AC	Zone:	ANAC	Category:	E	Rank:	P
Area:	35,840 SqFt	Length:	1,024 Ft	Width:	35 Ft				
Slabs:	Slab Length:	Ft	Slab Width:	Ft	Joint Length:	Ft			
Shoulder:	Street Type:	ACR	Grade:	0	Lanes:	0			
Section Comments:									
Work Date:	9/30/2010	Work Type:	New Construction - Initial		Code:	NU-IN	Is Major M&R:	True	
Work Date:	1/1/2019	Work Type:	Crack Sealing - AC		Code:	CS-AC	Is Major M&R:	False	
Work Date:	1/1/2019	Work Type:	Surface Seal		Code:	SS-LO	Is Major M&R:	False	
Work Date:	1/1/2024	Work Type:	Crack Sealing - AC		Code:	CS-AC	Is Major M&R:	False	
Work Date:	1/1/2024	Work Type:	Surface Treatment - Seal Coat		Code:	ST-SC	Is Major M&R:	False	
Last Insp. Date:	10/8/2024	TotalSamples:	7	Surveyed:	4				
Conditions:	PCI: 92								
Inspection Comments:									
Sample Number:	01	Type:	R	Area:	4900.00 SqFt	PCI:	96		
Sample Comments:									
48	L & T CR	L	35.00	Ft					
Sample Number:	02	Type:	R	Area:	4900.00 SqFt	PCI:	92		
Sample Comments:									
48	L & T CR	L	106.00	Ft					
Sample Number:	03	Type:	R	Area:	4375.00 SqFt	PCI:	92		
Sample Comments:									
48	L & T CR	L	91.00	Ft					
Sample Number:	07	Type:	R	Area:	3640.00 SqFt	PCI:	89		
Sample Comments:									
48	L & T CR	L	110.00	Ft					
57	WEATHERING	L	182.00	SqFt					

Network: 3U3 **Name:** Bowman Field (Anaconda) Airport

Branch: TW **Name:** Taxiway **Use:** TAXIWAY **Area:** 193,256 SqFt

Section: 22 of 6 **From:** RW 22 **To:** END **Last Const.:** 9/30/2010

Surface: AC **Family:** _MDT2024 - TW AC **Zone:** ANAC **Category:** D **Rank:** P

Area: 12,166 SqFt **Length:** 154 Ft **Width:** 79 Ft

Slabs: **Slab Length:** Ft **Slab Width:** Ft **Joint Length:** Ft

Shoulder: **Street Type:** ACR **Grade:** 0 **Lanes:** 0

Section Comments:

Work Date: 9/30/2010 **Work Type:** New Construction - Initial **Code:** NU-IN **Is Major M&R:** True

Work Date: 1/1/2019 **Work Type:** Surface Seal **Code:** SS-LO **Is Major M&R:** False

Work Date: 1/1/2019 **Work Type:** Crack Sealing - AC **Code:** CS-AC **Is Major M&R:** False

Work Date: 1/1/2024 **Work Type:** Crack Sealing - AC **Code:** CS-AC **Is Major M&R:** False

Work Date: 1/1/2024 **Work Type:** Surface Treatment - Seal Coat **Code:** ST-SC **Is Major M&R:** False

Last Insp. Date: 10/8/2024 **TotalSamples:** 2 **Surveyed:** 2

Conditions: PCI: 84

Inspection Comments:

Sample Number: 01 **Type:** R **Area:** 6083.00 SqFt **PCI:** 76

Sample Comments:

45 DEPRESSION L 259.00 SqFt

48 L & T CR L 107.00 Ft

57 WEATHERING L 608.00 SqFt

Sample Number: 02 **Type:** R **Area:** 6083.00 SqFt **PCI:** 92

Sample Comments:

48 L & T CR L 87.00 Ft

57 WEATHERING L 608.00 SqFt